

SITE DEVELOPMENT TABLE									
LOT NO.	AREA (ACRES)	MAX. ISR	ACTUAL ISR	USE	BUILDING AREA (SF)	PARKING SPACES	WATER DEMAND (GPM)	SEWER DEMAND (GPM)	AADT
LOT #1	2.20	60%	30%	OFFICE BLDG.	10,000	33	2.78	2.78	226
LOT #2	9.10	60%	37%	LIGHT IND.	82,500	57	22.92	22.92	515
LOT #3	8.00	60%	37%	LIGHT IND.	75,000	52	20.83	20.83	459
LOT #4	10.60	60%	34%	LIGHT IND.	105,000	70	29.17	29.17	683

- LEGEND:
- EXISTING PAVEMENT
 - EXISTING WETLAND
 - PROPERTY LINES
 - RIGHT OF WAY LINES
 - BUILDING SETBACKS
 - STORMWATER FACILITY
 - PROPOSED PAVEMENT

NOTES:
1. ALL DEVELOPMENT OUTSIDE OF THE PROPOSED RIGHT-OF-WAYS SHALL BE BY OTHERS

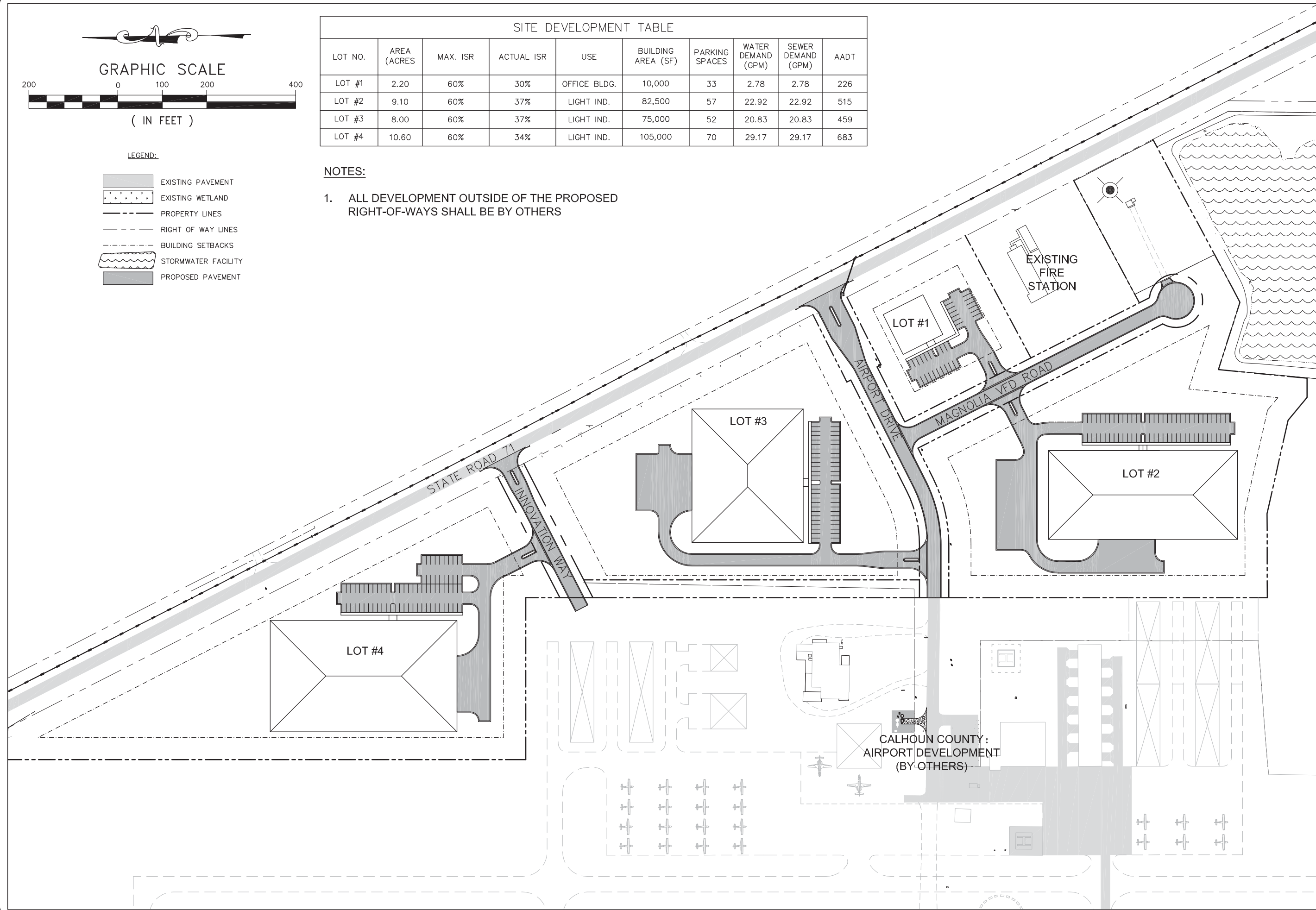

July 28, 2010 (09:31:14 EST)
 C:\DOCUMENTS\1\ROCHERS\LOCALS-1\TEMP\AC\PUBLISH_2408\013045_CAT_DSGN.DWG

PREBLE-RISH, INC. ALL RIGHTS RESERVED. NO PART OF THIS DOCUMENT MAY BE REPRODUCED OR UTILIZED IN ANY FORM WITHOUT PRIOR WRITTEN AUTHORIZATION OF PREBLE-RISH, INC.

PREBLE-RISH INC CONSULTING ENGINEERS AND SURVEYORS CIVIL • SURVEYING • SITE PLANNING	NO.	1	DATE		APPR.
	NO.	2	DATE		
	NO.	3	DATE		
	NO.	4	DATE		
	NO.	5	DATE		

5365 SCIENCE HWY 30A, SUITE 104
 20884 CENTRAL AVENUE EAST
 203 ABERDEEN PARKWAY
 324 MARINA DRIVE
 JACKSONVILLE, FL 32216
 JACKSONVILLE, FL 32244
 JACKSONVILLE, FL 32244
 JACKSONVILLE, FL 32244
 (850) 237-7200
 (850) 922-2844
 (850) 231-3902
 (850) 674-3300

OVERALL SITE PLAN
CATALYST SITE
CALHOUN COUNTY, FLORIDA

PROJECT NO.
013.045

SHEET
C1

DATE:
 DEC. 2009

SCALE:
 AS SHOWN

DRAWN:
 B.ROCHER

CHECKED:
 T.JUSTICE